

**SONODYNE**

SSW 2010

front firing powered subwoofer • owners manual

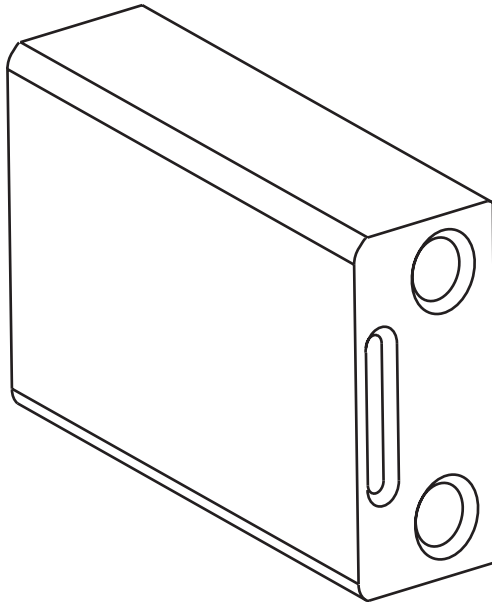

**MADE IN INDIA**  
since 1970

## INTRODUCTION

The SSW 2010 is a stereo passive subwoofer with both direct (4 Ohm) and 70/100V input, and a pair of highpass outputs for satellite speakers.

With 70V input, 3 different power taps are available: 7.5W, 15W and 30W. With 100V input, 15W, 30W and 60W are available, by connecting to the respective input terminal. Selection between inputs (direct and 70/100V) is carried out with a slide switch.

Also provided is a mode switch which provides stereo mode operation and mono mode operation (in case of 70/100V input). In mono mode, the subwoofers are connected in series while the highpass output is available from the left channel only.

Connection to the subwoofer is via Euroblock terminals which greatly facilitates wiring.

## UNPACKING

Cut open the tape and open the flaps. Remove the EPE buffer. Lift the unit out of the box and remove all protective covers. Please ensure that the following are attached to the rear of the unit.

1. 2 x wall-mount brackets fitted to the rear plate
2. 3 x female headers of Euroblock terminals

Inspect the speaker for any sign of damage. Please retain all packing materials in case you have to transport the unit in future.

# DIMENSION • PRODUCT DRAWING

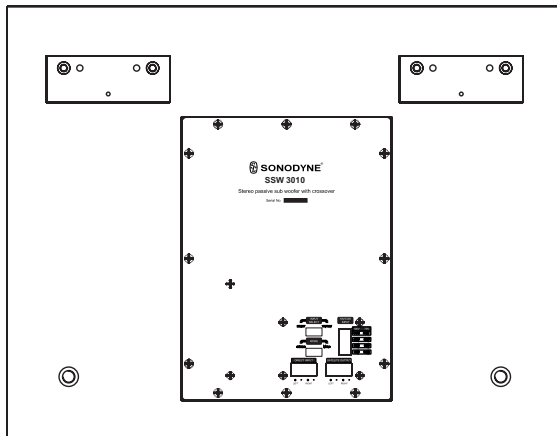
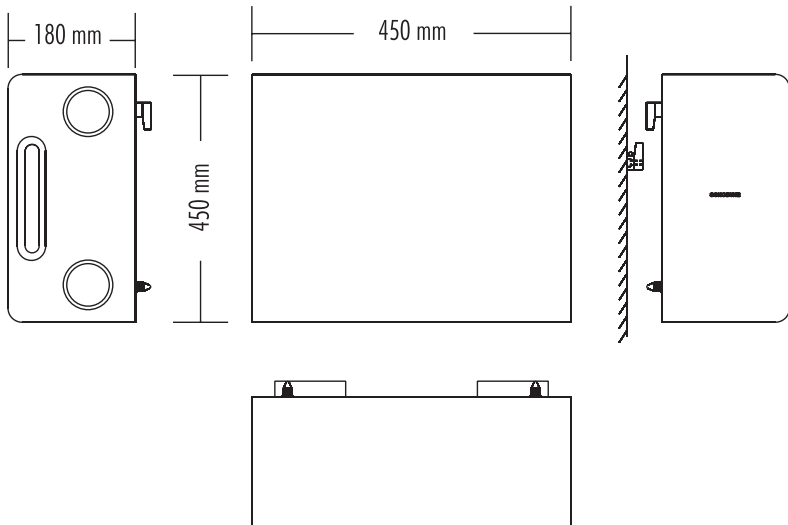

# MOUNTING

The SSW 2010 comes fitted with wall mount brackets so that you can hang it on the wall. Please follow the steps given below

The wall mount bracket of SSW 2010 consists of 2 parts - one that is fitted to the cabinet and the other part to be fitted on the wall. There are 2 such sets. The wall mounting part is held to its cabinet counterpart with a fish-plate and 2 screws, for transit purposes. First open the 4 screws, and remove the plate. Please see Fig.1 below

FIG.1

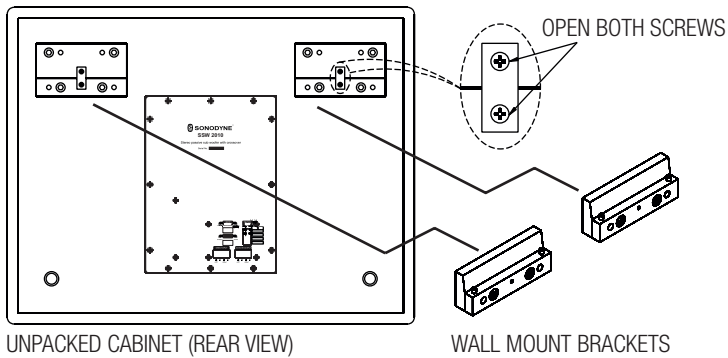

Next, drill holes on the wall for the screws supplied, as per the following diagram, where you want to mount the SSW 2010. Please see Fig. 2 below

STEP 1  
FIG.2

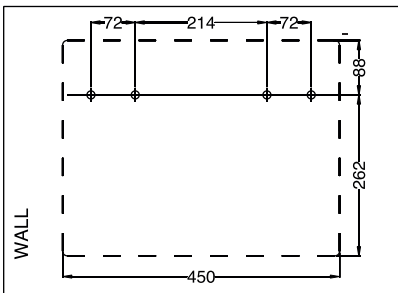

Now fit the wall mounting brackets to the wall with the help of the screws supplied. Please see Fig. 3 below

STEP 2  
FIG.3

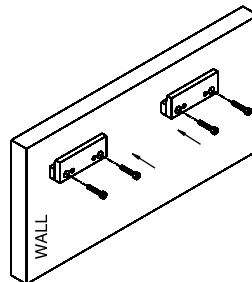

Hold the cabinet vertically and align it, so that the tongue of the cabinet bracket is just above the groove on the wall bracket. Lower the cabinet so that the pins on the cabinet bracket engage with the corresponding holes on the wall bracket. Please see Fig. 4 below

## STEP 3: MOUNT THE CABINET FIG. 4

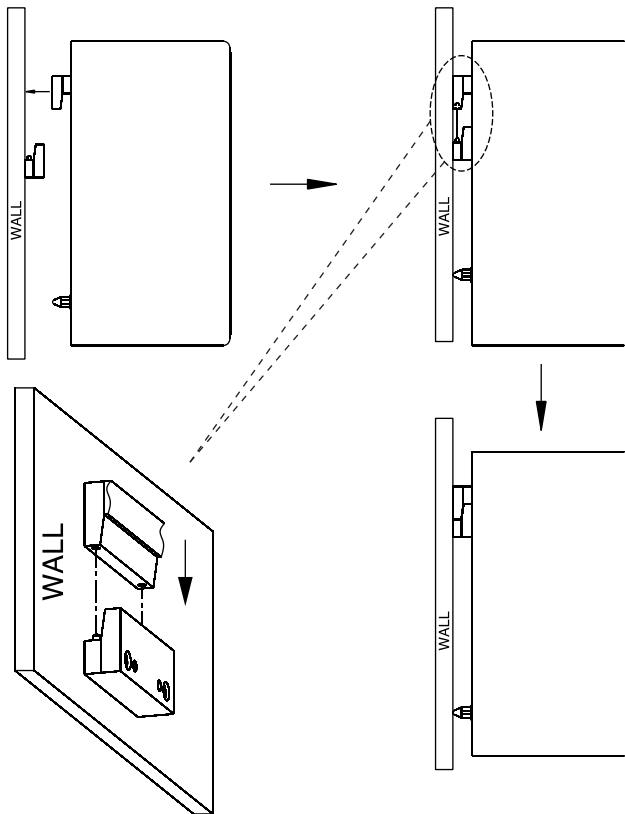

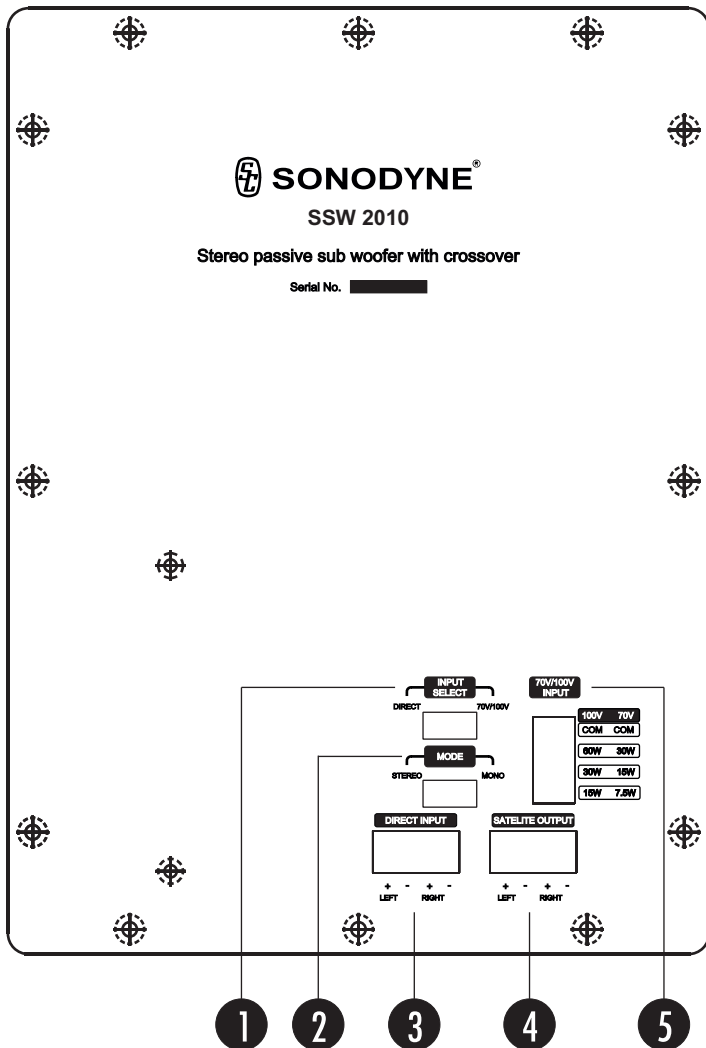

### 1. INPUT SELECT SWITCH

This is a slide switch for input selection. When connecting the 4 Ohm speaker output of your amplifier to the input of the SSW 2010, keep the switch in DIRECT mode. When connecting the 70V or 100V output of your amplifier, keep it in 70/100V position.

### 2. MODE SWITCH

This is a slide switch for stereo/ mono mode. If you have connected to channels of your amplifier output to the input of the SSW 2010, keep the mode switch in stereo position. If, however, the input is mono, as for instance, 70/100V output of an amplifier, keep the switch in mono position. In mono mode, the subwoofers are connected in series while the high-pass output is available from the left channel only. Do not connect speaker to right input and amplifier output to right input as this may cause malfunctioning.

### 3. DIRECT INPUT

Connect the 4 Ohm speaker output of your amplifier to these terminals. there is a pair of terminals - one for left channel and the other for right channel. Take care to observe correct polarity while making connections

### 4. SATELLITE OUTPUT

Connect your satellite speakers to these terminals. There is a pair of terminals - on for left channel and the other for right channel. In stereo mode, the impedance of satellite speakers should be 4 Ohm for each channel. In mono mode, the satellite speaker connected to the left channel will only play. The impedance of this speaker should be 8 Ohm.

### 5. 70/100V INPUT

Connect the 70/100V output of your amplifier to this terminal

It consist of a COM pin and 3 pins for different power taps. The power tap marking of 70V and 100V are printed on the rear plate. Connect the amplifier to the COM pin and any of the power tap pins.

# SPECIFICATIONS

---

|                               |  |
|-------------------------------|--|
| DESIGN                        | Front firing powered subwoofer, vented |
| ENCLOSURE                     | MDF                                    |
| TRANSDUCER COMPLEMENTS        | 1 x 6" dual voice-coil subwoofer       |
| FREQUENCY RANGE (-10dB)       | 45Hz ~ 200Hz                           |
| FREQUENCY RESPONSE (-3dB)     | 50Hz ~ 200Hz                           |
| SENSITIVITY (1W 1M)           | 88dB (half space)                      |
| SPL @ RATED POWER             | 105dB @ 60W                            |
| IMPEDANCE, DIRECT INPUT       | 4 Ohm + 4 Ohm (stereo), 8 Ohm (mono)   |
| AMPLIFIER POWER, DIRECT INPUT | 100W + 100W                            |
| POWER TAPS 70V                | 7.5W, 15W, 30W                         |
| POWER TAPS 100V               | 15W, 30W, 60W                          |
| IMPEDANCE 70V                 | 653, 327, 163 Ohm                      |
| IMPEDANCE 100V                | 666, 333, 167 Ohm                      |
| DIMENSIONS (H x W x D) MM     | 350 x 450 x 180                        |
| COLOUR                        | White/ Black                           |
| MOUNTS                        | Wall-mounting brackets                 |
| NET WEIGHT                    | 12.2kg                                 |
| GROSS WEIGHT                  | 14.7kg                                 |

*NOTE: Due to continuous improvements, all specifications are subject to change*

## SONODYNE

SONODYNE, India • H.O.: 98 NB Block E New Alipore, Kolkata 700053

---

 sonodyneofficial

 +91 9830855260

 SonodyneMusic

 response@sonodyne.com

 sonodyneofficial

 www.sonodyne.com