

DESCRIPTION • INSTALLATION • SPECIFICATIONS

DESCRIPTION

Thank you for choosing the Sonodyne SGS 101. In gardens and pool sides, where wall mounting speakers are not an option, the SGS 101, with its unique looks, is a perfect fit. The SGS 101 has a high grade 6" coaxial transducer with exceptional sound quality. It is 100% water-proof and has 100V connectivity option.

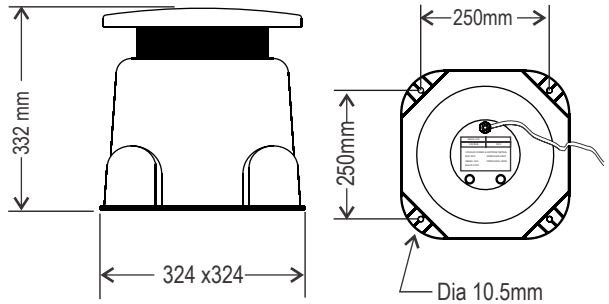

INSTALLATION

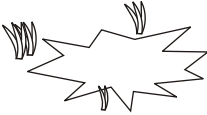
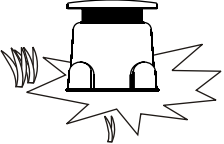
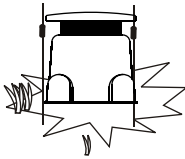
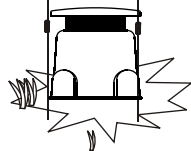
<p>STEP 1: Find a strip of hard soil on the grass/ground of about 400mm x 400mm minimum size</p> 	<p>STEP 2: Place the garden speaker carefully on the ground</p> 
<p>STEP 3: Fix the garden speaker to the ground with screws</p> 	<p>STEP 4: After installation, complete the connections with 100V lines</p> 

SPECIFICATIONS

DESCRIPTION	Water-proof mushroom speaker	SENSITIVITY	88dB
ENCLOSURE	Plastic	FREQ. RANGE	80Hz ~ 18.5kHz (-10dB)
TRANSDUCERS	1 x 6" coaxial speaker	SPEAKER TERMINAL	3 core cable
SPL @ RATED POWER	102dB @ 30W	DIMENSION (HxWxD)	332 x 324 x 324 mm
POWER TAPS	GREEN: 10W, 1kΩ RED: 20W, 500Ω	WEIGHT	3.5kg

NOTE: Due to continuous improvements, all specifications are subject to change

SONODYNE

SONODYNE, India • H.O.: 98 NB Block E New Alipore, Kolkata 700053

 sonodyneofficial

 SonodyneMusic

 sonodyneofficial

 +91 9830855260

 response@sonodyne.com

 www.sonodyne.com